

Legend

- Timber Sale Boundary
- Ownership
- ⊗ No Harvest Area
- ▨ Stream Buffer
- ⊕ Green Tree Retention Area
- Surfaced Road
- == Unsurfaced Road
- ⋯ Type N Stream
- + Project Point
- ◇ Land Survey Monument

EXHIBIT "A"

OF TIMBER SALE CONTRACT NO. WO-341-2026-W01269-01
 LONELY BEAVER
 PORTIONS OF SECTION 20, T11S, R09W, W.M.,
 LINCOLN COUNTY, OREGON

| | GROSS AREA | NET ACRES | ACRES |
|--------------|------------|-----------|-------|
| 1 | 60 | 48 | |
| Total | 60 | 48 | |

This product is for informational use and may not have been prepared for or be suitable for legal, engineering or survey purposes. Variations may exist between and among data sets in use by the Department of Forestry. Users of this information should review or consult the primary data and information sources to ascertain the usability of this information.

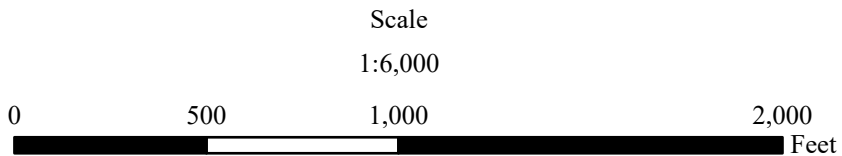

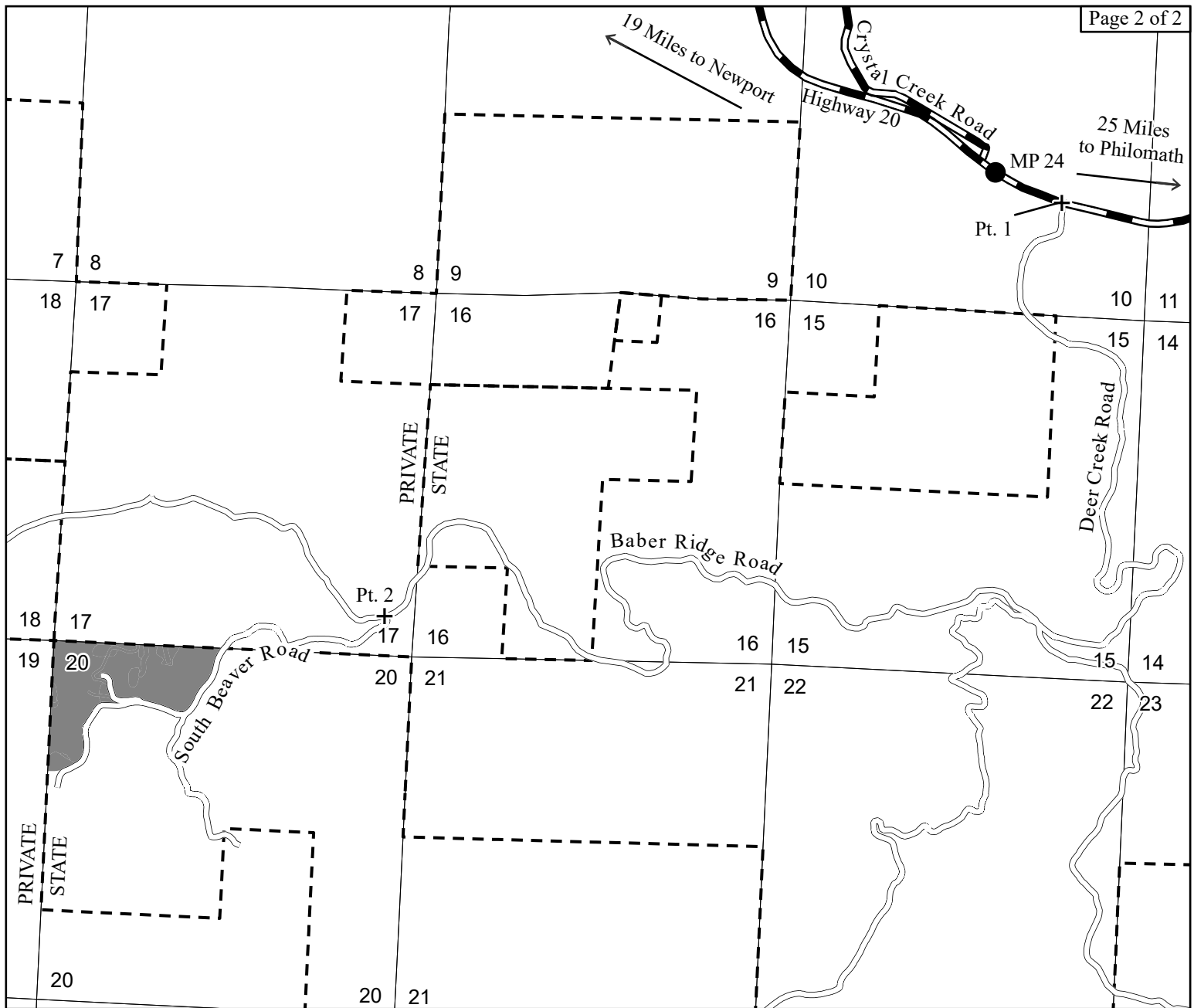

Legend

- Timber Sale Area
- Ownership
- Highway
- Surfaced Road
- Project Point

EXHIBIT "A"
 VICINITY MAP
 OF TIMBER SALE CONTRACT NO. WO-341-2026-W01269-01
 LONELY BEAVER
 PORTION OF SECTION 20, T11S, R09W, W.M.,
 LINCOLN COUNTY, OREGON

This product is for informational use and may not have been prepared for or be suitable for legal, engineering or survey purposes. Variations may exist between and among data sets in use by the Department of Forestry. Users of this information should review or consult the primary data and information sources to ascertain the usability of this information.

